

KAS-PSL9120 Slim Professional Column Line Array Speaker



DESCRIPTION

The ULTRAKPA decorative elegant series of professional column line arrays with enhanced aesthetics providing a sleek appearance that blends seamlessly with various setups and environments delivering consistent horizontal directivity, ensuring uniform sound projection over long distances. Each array is equipped with eight 3-inch full-range drivers, providing exceptional vocal clarity and superior coherent sound quality.

Engineered for easy stacking or arraying for enhanced coverage and output, designed for ease of installation and operation, the new ULTRAKPA column arrays excel in intelligibility, designed to produce maximum output with minimal input power, enhancing overall efficiency. These features offer this series a distinct competitive advantage in the market.

The KAS-PSL9120 utilizes advanced materials to reduce weight, facilitating easier transport and setup. As with all ULTRAKPA products, reliability, performance, and quality remain central to our loudspeakers, all at a competitive cost.

MAIN APPLICATIONS

- Medium Sized Auditoriums, Professional Studios, Theatres and Live Musical Performances
- Corporate A/V professionals, Conference Halls and Large Meeting Rooms
- House of Worship, Hospitality Venues, Education and Large Training Centers

MAIN FEATURES

- **Excellent Intelligibility and Sound Quality**
- **Selective Power 70V, 100V, 8 Ohm**
- **8 x 3" Full Range Drivers**
- **Reliable Performance**
- **Significant Vocal Clarity**
- **For Professional Voice and Music Reinforcement**
- **Wide and Even Sound Coverage**
- **Up to 115.5 dB max. SPL**
- **Innovative Design**
- **Easy Installation**
- **CE Listed**

KAS-PSL9120 Slim Professional Column Line Array Speaker

TECHNICAL SPECIFICATIONS

COMPONENTS

Speaker type	Full range
Drivers	8 x 3" 20 mm voice coil

ELECTRICAL

Effective frequency range, Hz	180 - 18000
S.P.L., @ 1 m, 1 Watt, 1 kHz, dB	95
S.P.L., @ Full power / 1 m, dB	115.5
Horizontal beamwidth, degree	90
Vertical beamwidth, degree	30
Crossover frequency	4KHz

POWER

Rated power (RMS), watts	120
Program power, watts	240
Driver impedance, ohms	8
Input voltage, volt	70, 100
Selectable power, watts	60, 30, 15, 7.5
System impedance, ohms	70V 667, 333, 167, 83 100V 1333, 667, 333, 167

INTERFACE

Connectors	High quality sockets Phoenix
------------	---------------------------------

ENVIRONMENT

Storage Temperature	-20°C to +70°C, -4° to 158°F
Operation Temperature	0°C to +40°C, 0°F to 104°F
Humidity (non condensing)	80%RH to at least +65°C 80% RH to at least-149°F
Altitude	3000 meter, 10000 feet maximum

MECHANICAL

Dimensions (W x H x D), mm	98 x 730 x 130
Net weight, Kgs	7.5
Enclosure material	Light weight plywood Heavy duty 0.8 mm metal grille
Finish	Resistant paint
Color	White: KAS-PSL9120W Black: KAS-PSL9120B

SPL VS FREQUENCY

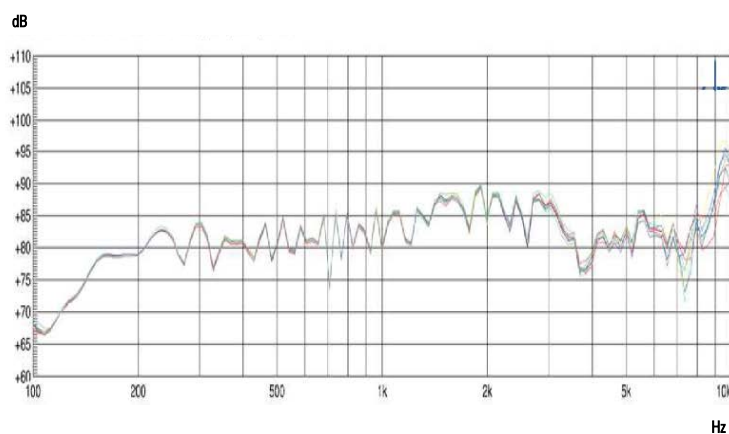

FREQUENCY RESPONSE (1W,4M)

INSTALLATION OPTIONS (Via Optional Brackets)

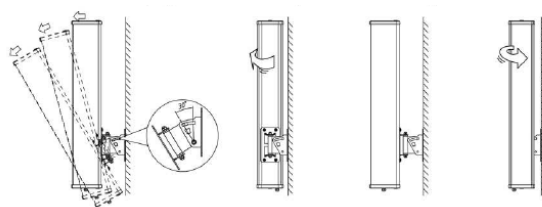

180°X30° Bracket (Horizontally: ±90°, Vertically: 0°~30°)

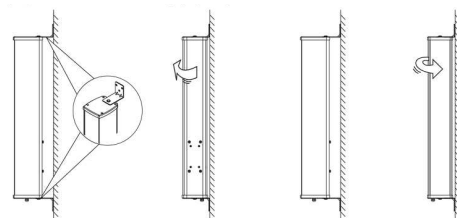

L Bracket: (Horizontally: ±90°)



Every effort has been made to ensure that all the information in this document was correct at the time of going to press. However we are constantly striving to improve our range wherever possible and therefore reserve the right to change the specification of any product without prior notice.

R&D is constantly improving our products therefore specifications, features and appearance are subjected to change without notice

ULTRAKPA

For USA, Canada, South America, Europe, Africa & Middle East - info@ultrakpa.com

ULTRAKPA Inc

Astoria, NY 1103, U.S.A

Phone + 1 (914) 210-1483 info@ultrakpa.com

www.Ultrakpa.com