

KAS-0506N/WF Metal Ceiling Loudspeaker



DESCRIPTION

Introducing the KAS-0506N/WF, a 6-watt full-range loudspeaker with a steel-coated chassis that boasts a unique combination of style and performance that is unparalleled in its class. This cutting-edge loudspeaker is designed to excel in applications where clear and intelligible speech and music reproduction are paramount. The KAS-0506WF delivers outstanding sound clarity, making it ideal for use in commercial, industrial, and institutional settings.

The KAS-0506N/WF is engineered for effortless installation with its quick-release spring clamp mechanism, ensuring a hassle-free setup. This feature, coupled with its outstanding performance, makes the KAS-0506N/WF an effective solution for voice transmission, music reproduction, and signal amplification in a wide range of applications.

Don't settle for subpar audio quality -upgrade to the KAS-0506N/WF and experience the best in sound performance and style.

MAIN APPLICATIONS

- Background music and Public Address Applications in Meeting Rooms, Hospitality Venues, Retail Stores, Administrative Buildings, Hospitals, Conference Rooms, Classrooms, Restaurants, and Other Public Spaces.

MAIN FEATURES

- **Carefully Designed to Satisfy the Most Critical Eye**
- **High Intelligibility and Sound Clarity**
- **Wide Dispersion Angle**
- **Robust Steel Chassis**
- **Provides an Exceptional Blend of Style and Performance**
- **Suitable For Both Music and Speech**
- **Simple and Quick Fixation**
- **Outstanding Sound Clarity**
- **Decorative Design**
- **CE and UL Approved**

KAS-0506N/WF Metal Ceiling Loudspeaker

TECHNICAL SPECIFICATIONS

POWER

Rated Power, Watts	6/3
Line Voltage, Volts	100/70
Impedance, Ohms	1.67K
Effective frequency range, Hz	90- 16,500
S.P.L., @ 1m, 1 watt, dB	90
S.P.L., @ Full power / 1m, dB	98
Dispersion at 1,000 Hz, Degrees	180

ENVIRONMENT

Storage Temperature	- 20°C to +70°C, -4° to 158°F
Operation Temperature	0°C to +40°C, 0°F to 104°F
Humidity	80%RH to at least +65°C
(non condensing)	80% RH to at least-149°F
Altitude	3000 meter, 10000 feet max.

MECHANICAL

Dimensions front and depth, mm	φ180 x 55
Net weight, Kgs	0.7
Enclosure material	Metal grille
Finish	Resistant paint
Color	White
Mounting	Quick-release, spring clamp

DIMENSIONS

Unit: mm

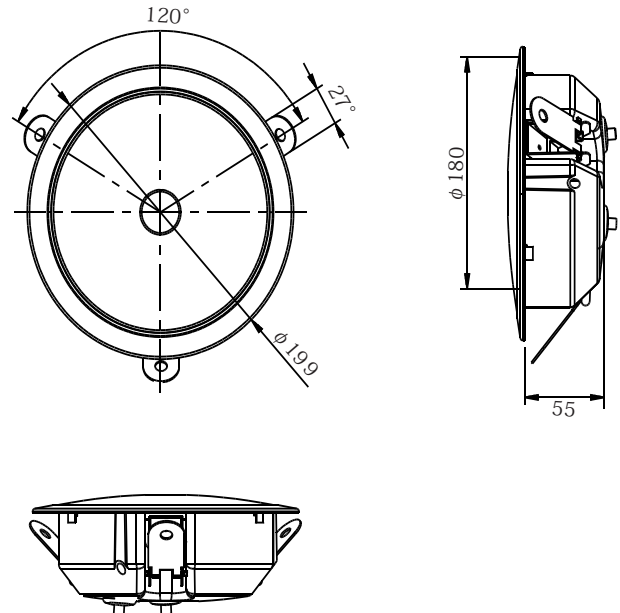

Conversion: 1" = 25.4mm
Measurement conversions are approximate
Images are illustrative

SPL vs. FREQUENCY

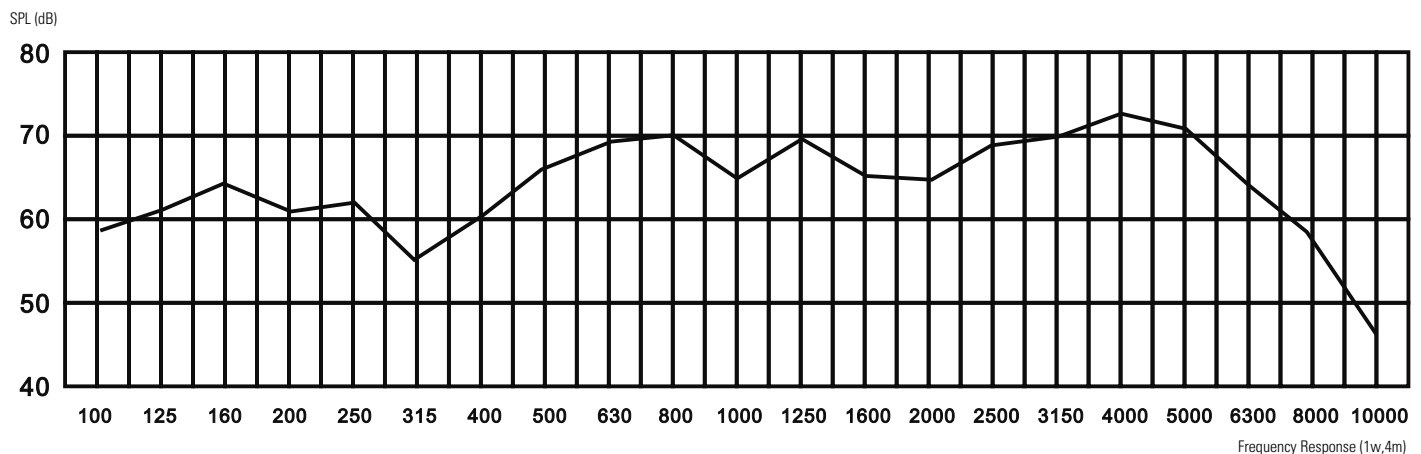

Every effort has been made to ensure that all the information in this document was correct at the time of going to press. However we are constantly striving to improve our range wherever possible and therefore reserve the right to change the specification of any product without prior notice.

R&D is constantly improving our products therefore specifications, features and appearance are subjected to change without notice

ULTRAKPA

For USA, Canada, South America, Europe, Africa & Middle East - info@ultrakpa.com

ULTRAKPA Inc

Astoria, NY 1103, U.S.A

Phone + 1 (914) 210-1483 info@ultrakpa.com

www.Ultrakpa.com